

Aeration and Vent Valve



ISO 9002 CERTIFIED

Body:	PVC, PP, PVDF
Ball:	PP
Size:	1/2" - 2"
Pressure Rating:	150 psi
Seals:	FPM
Connections:	Spigot

Materials of Construction:

PVC: Type 1, Class 12454B, ASTM D1784

PP: Class PP 110B76383, ASTM D4101

PVDF: Type 1, ASTM D3222

Seals: FPM

When fluid is removed from a tank, the valve ball/float is located at the bottom of the valve. Air or protective gas can flow into the container, providing pressure compensation to ensure that the tank is not damaged by a vacuum. When the container is filled again, the air/protective gas escapes through the valve into the atmosphere until the fluid level reaches the valve ball/float. When the container is filled further, the valve ball/float rises with the fluid level and seals the container at the valve seat.

Features

- Mounting in vertical position only
- High level of operating safety and long service life
- When the valve is closed, venting is only possible when the container pressure falls below the atmospheric pressure even with air build-up (outgassing media).
- The valves are not suitable for fluids that clog or gum up the balls/floats, impairing their opening and closing action.
- Low-maintenance

Pressure/Temperature Graph

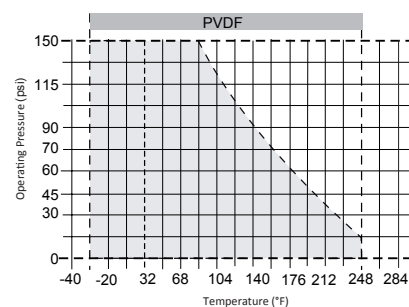
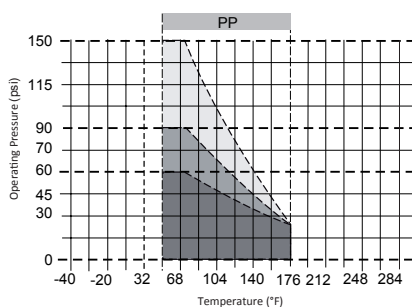
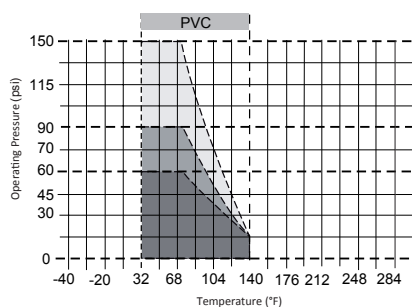

The pressure/temperature limits are applicable for the stated nominal pressures and a computed operating life factor of 25 years. These are standard values for harmless media (DIN 2403), to which the valve material is resistant. For other media please refer to the chemical resistance guide. The durability of wear parts depends on the operating conditions of the application. For temperatures below 32°F (PP < +50°F) please specify the precise operating conditions of the application. The rated pressure depends on the valve size and material.

Dimensional Data - Spigot

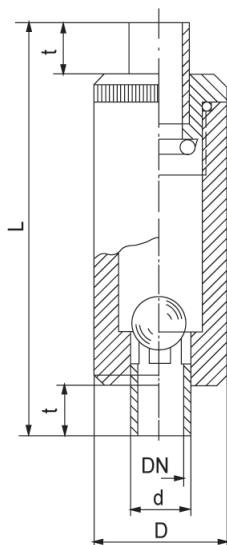

NOM. Size	d	D	L	t
½"	0.79	1.57	4.88	0.63
¾"	0.98	1.77	5.67	0.75
1"	1.26	2.17	6.06	0.87
1¼"	1.57	2.76	6.85	1.02
1½"	1.97	3.15	7.64	1.22
2"	2.48	3.74	8.82	1.50

Part Listing

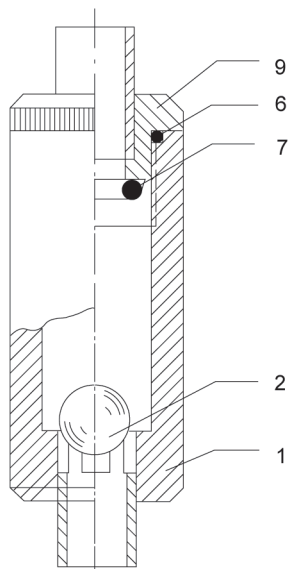

POSITION	Description	Qty
1	Housing / Body	1
2	Ball	1
6	O-Ring	2
7	O-Ring	1
9	Bonnet	1